

How to Access Report Cards and Progress Reports in Parent Connection

Using the Parent Connection Mobile App

1. Log in with your PIN and password

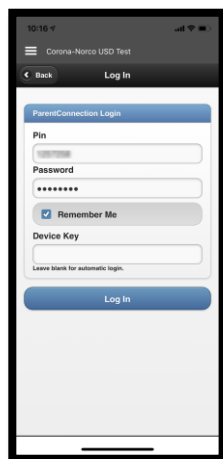

2. Select your student in the *My Students* list

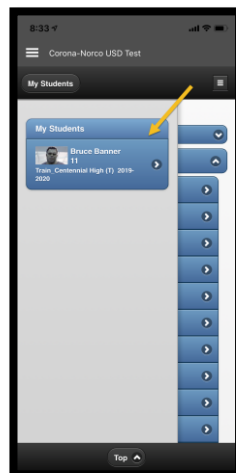

3. Select the *Student Documents* or *Marks* module

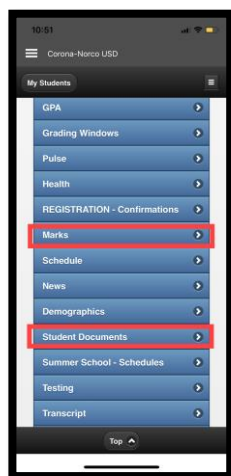

4a. In *Student Documents*, find the document you are looking for and select the *Open Document* link

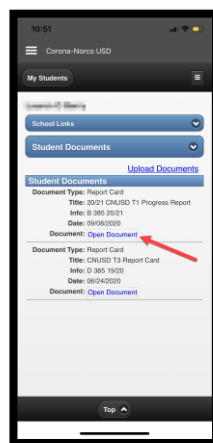

4b. In *Marks*, select the current grading window and select the report card/progress report button

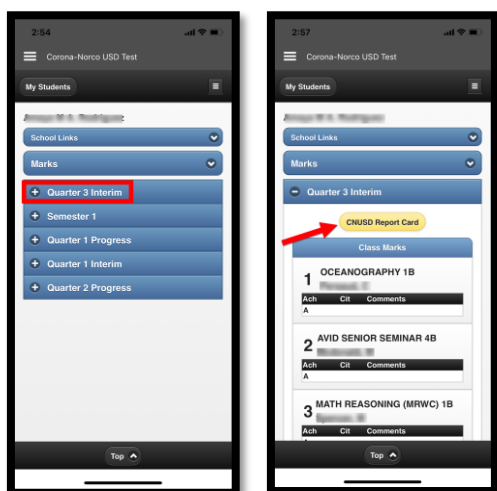

5. View your students' report card/progress report

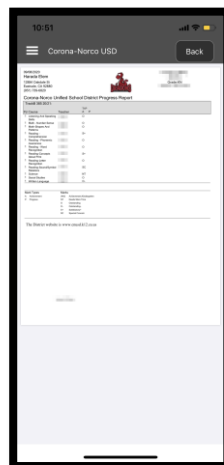

Using the Parent Connection Website

1. Log in with your PIN and password

ParentConnection Login

CORONA-NORCO

PIN:

Password:

Log In

[Need Your Login Information?](#)

District Links

[CNUSD District Website](#)

[CNUSD School Directory](#)

[CNUSD Connection](#)

2. Select your student

ParentConnection

Welcome

Student Name	Grade	School Name
Click on a student to view their information.	12	Train_Centennial High (T)
Bruce Banner	11	Train_Centennial High (T)
Bruce Banner	12	Train_Centennial High (T)

3. Select the *Student Documents* or *Marks* module

ParentConnection

Student Name: Harada Elem

Grade: KN

Attendance

Activities

Behavior

Checked Out Devices

Assignments

Contacts

Enrollment

GPA

Grading Windows

Pulse

Health

REGISTRATION - Confirmations

Marks

Schedule

News

Demographics

Student Documents

Summer School - Schedules

Testing

4a. Under *Student Documents* find the document you are looking for and select the *Open Document* link

Title	Info	Date	Document
20/21 CNUSD T1 Progress Report	B 385 20/21	09/08/2020	Open Document
CNUSD T3 Report Card	D 385 19/20	06/24/2020	Open Document

4b. Under *Marks* select the hyperlink for the current grading window

Period	Course	Teacher
1	OCEANOGRAPHY 1B	
2	AVID SENIOR SEMINAR 4B	
3	MATH REASONING (MRWC) 1B	
4	LEADERSHIP ETHNIC ADVISORY	
5	GOVERNMENT	
6	CSU EXPOSIT READING & WRITING B	

5. The report card will be downloaded in PDF format

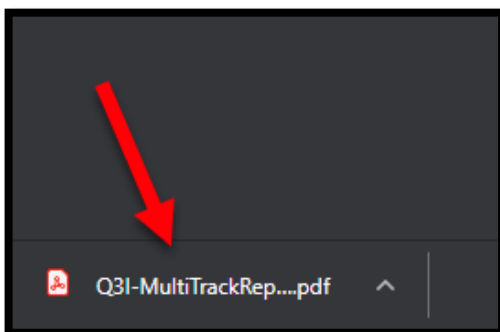

6. Click on the PDF to view your students' report card

04/07/2020

Train_Centennial High

1820 Rimpau Ave

Corona, CA 92881

(951) 739-5670

TrackT 720 19/20:

Per	Course	Teacher	Q3I	A	C	Crd	Awd	Abs
1	OCEANOGRAPHY C		A			0.0000	1	
2	AVID SENIOR SEMINAR		A			0.0000	1	
3	MATH REASONING M		A			0.0000	1	
4	LEADERSHIP ETHNIC C		A			0.0000	2	
5	GOVERNMENT M		A			0.0000	2	
6	CSU EXPOSIT REAJ		A			0.0000	1	
Term Averages						Overall Totals:	0.0000	8

Mark Types

A: Achievement

C: Citizenship

Marks

(Ach) Achievement, Grades 7-12

A Superior Achievement

GPA/Credit Summary None